

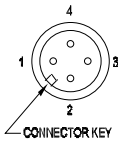

Features

- M12 connector
- Hermetic seal
- Rugged design
- Corrosion resistant
- Case isolated
- ESD protection

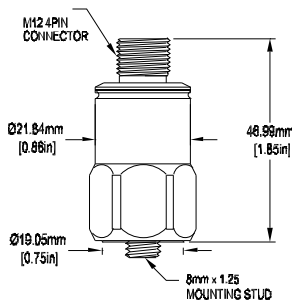
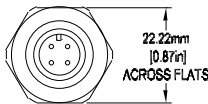

786A-M12 General purpose accelerometer

Dynamic

Sensitivity, ±5%, 25°C	100 mV/g
Acceleration range	80 g peak
Amplitude nonlinearity	1%
Frequency response:	
± 5%	3 - 5,000 Hz
±10%	1 - 9,000 Hz
± 3 dB	0.5 - 14,000 Hz
Resonance frequency	30 kHz
Transverse sensitivity, max	5% of axial
Temperature response:	
-50°C	-5%
+120°C	+5%

Electrical

Power requirement:	voltage source	18 - 30 VDC
	current regulating diode	2 - 10 mA
Electrical noise, equiv g:		
Broadband 2.5 Hz to 25 kHz		700 µg
Spectral 10 Hz		10 µg/√Hz
100 Hz		5 µg/√Hz
1000 Hz		5 µg/√Hz
Output impedance, max		100 Ω
Bias output voltage		12 VDC
Grounding		Case isolated, internally shielded

Environmental

Temperature range	-50 to 120°C
Vibration limit	500 g peak
Shock limit	5,000 g peak
Electromagnetic sensitivity, equiv g, max	70 µg/gauss
Sealing	Hermetic
Base strain sensitivity, max	0.0002 g/µstrain

Physical

Sensing element design	PZT ceramic / shear
Weight	90 grams
Case material	316L stainless steel
Output connector	4 pin, M12-style
Mating connector	M12-style
Recommended cabling	J10 / J12
Mounting	stud, SF6M (M8)

Connector pin	Function
Shell	Ground
Pin 1	Power / signal
Pin 2	Common
Pin 3	N/C
Pin 4	N/C

Accessories supplied: SF6M mounting stud; calibration data (level 2)

Wilcoxon Research Inc
20511 Seneca Meadows Parkway
Germantown, MD 20876
USA

Tel: 301 330 8811
Fax: 301 330 8873
Email: wilcoxon@meggitt.com

www.meggitt.com

